

**Shelter #1**

- Capacity: 100 people
- # of Picnic Tables: 8
- Closest to restrooms, tennis courts, skateboard park
- Distance to Restrooms: 220'

**Shelter #2**

- Capacity: 100 people
- # of Picnic Tables: 7
- Distance to Restrooms: 475'

For reservations or questions  
call 222-6455

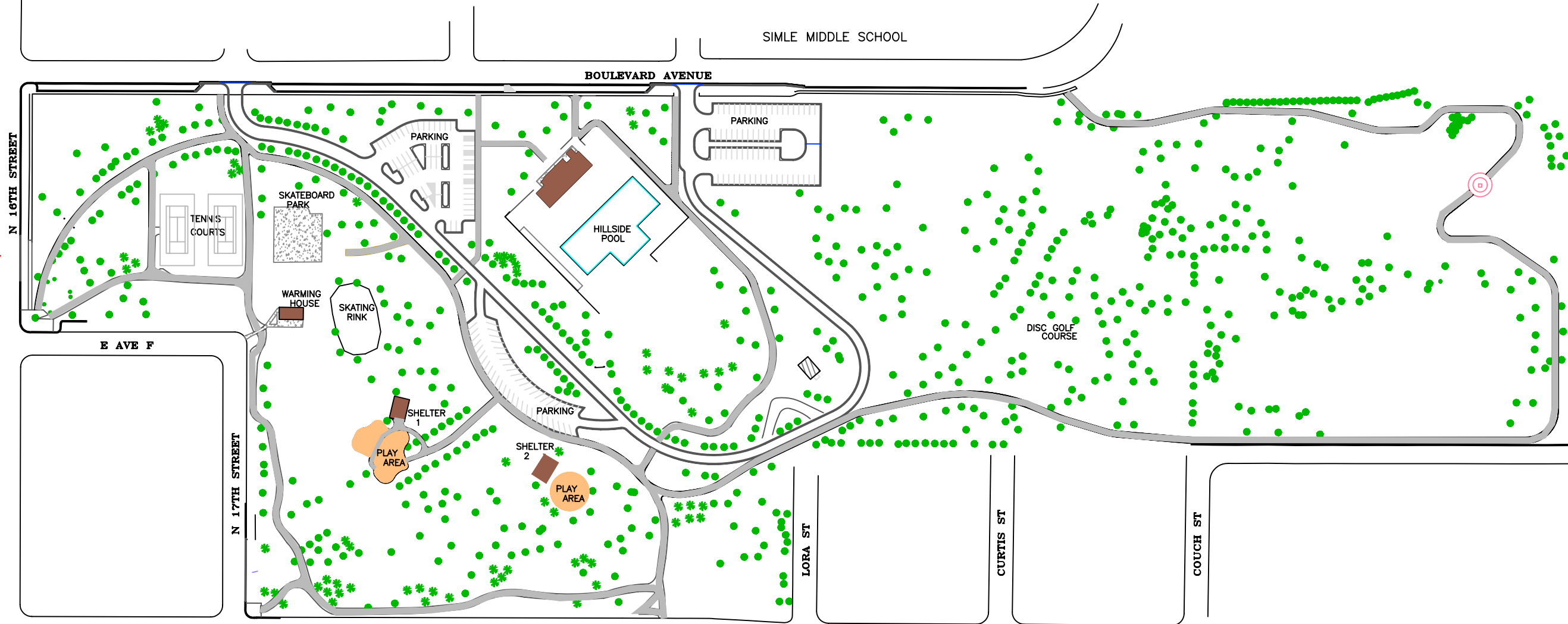
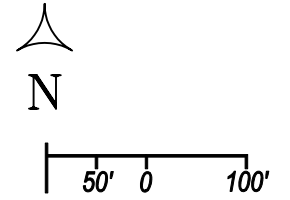

**BISMARCK PARKS AND RECREATION DISTRICT**  
Est. 1927  
400 East Front Avenue Bismarck, ND 58504  
701-222-6455 [www.bisparks.org](http://www.bisparks.org)

Lions Park/Hillside Pool