



NATIONAL GOLD MEDAL WINNER
**BISMARCK PARKS AND
RECREATION DISTRICT**
Est. 1927

Feasibility Study for Indoor Community Recreation Complex

Conceptual Programming and Facility Plans

October 16, 2019



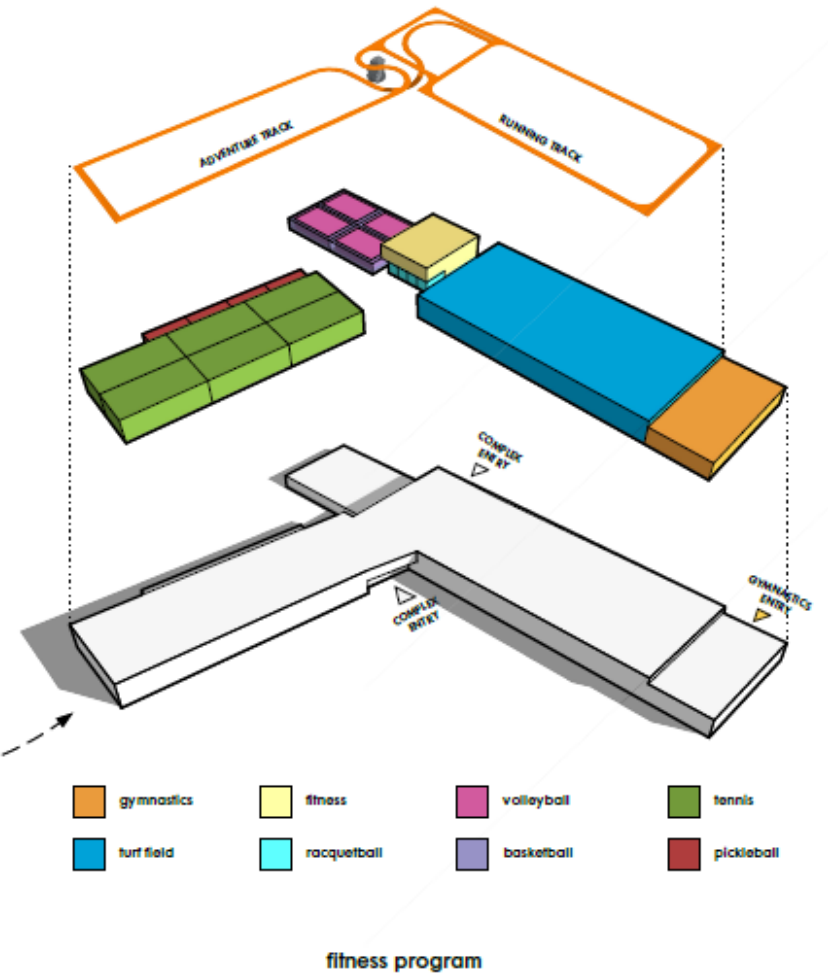
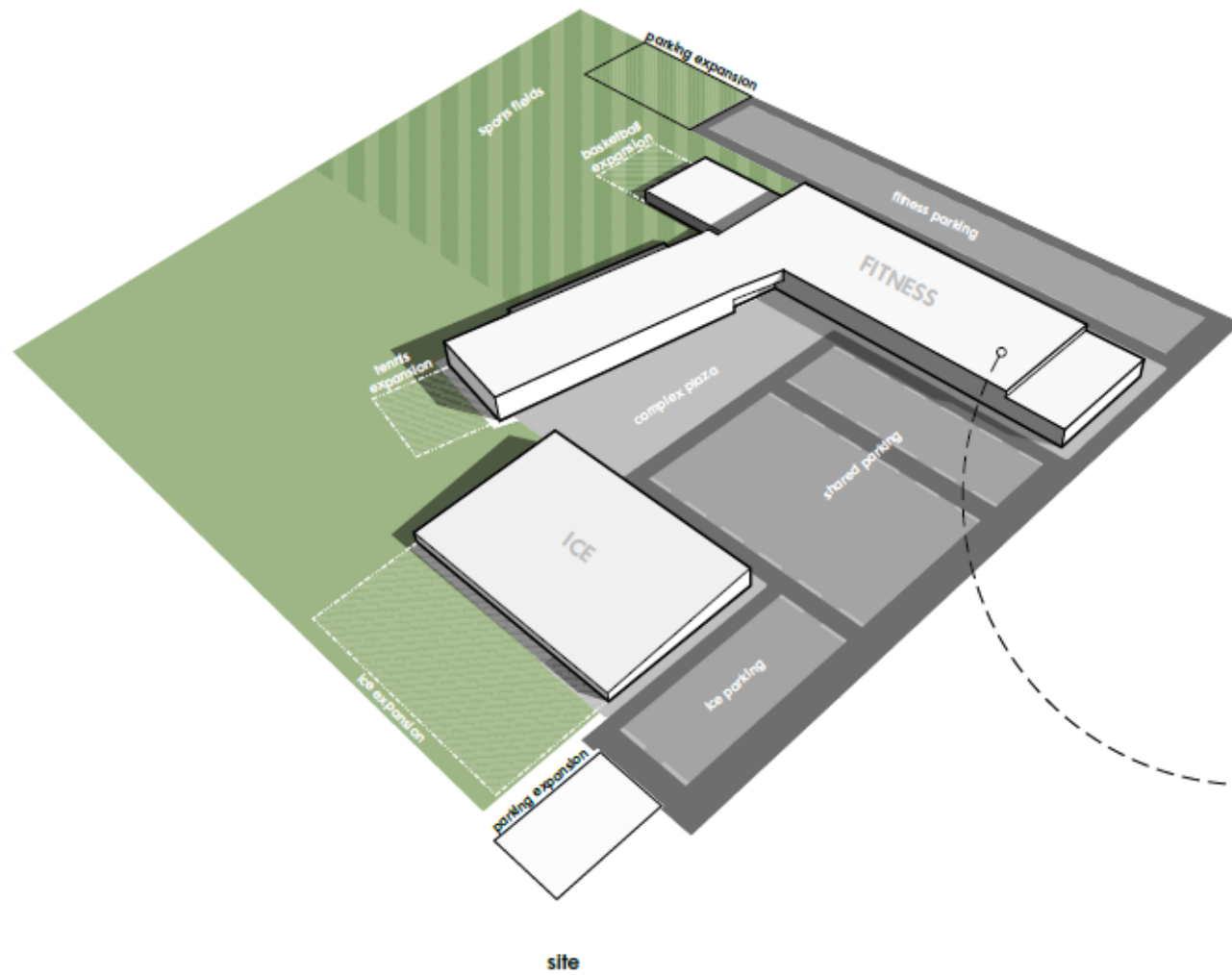

PROGRAMMING

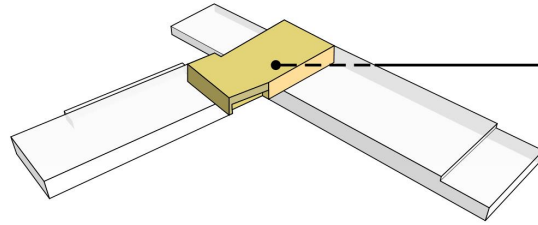

wellness area

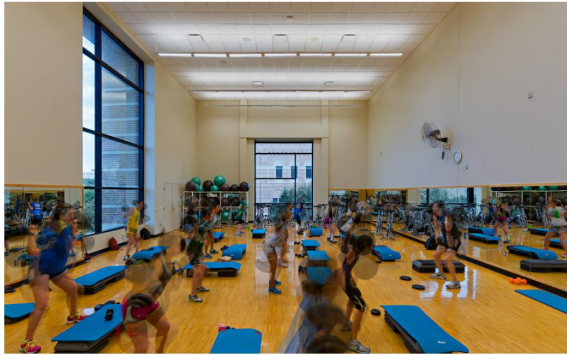

exterior amenities



PROGRAMMING

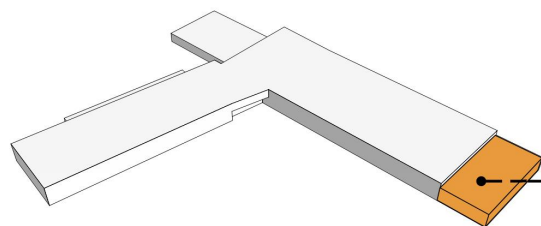

gymnastics

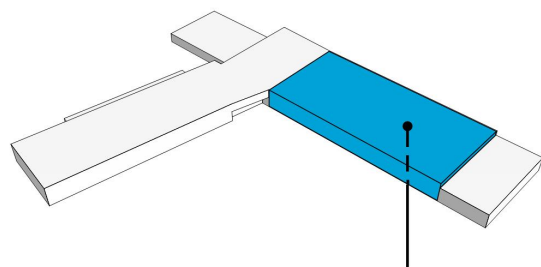
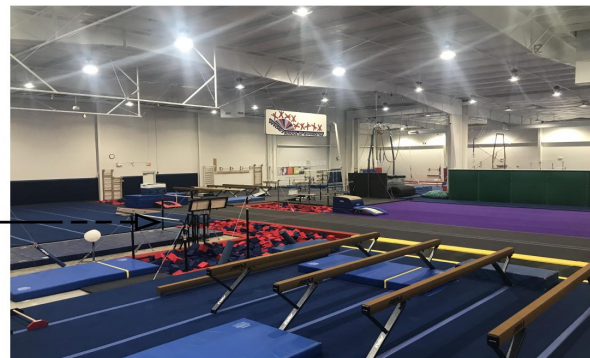

turf field

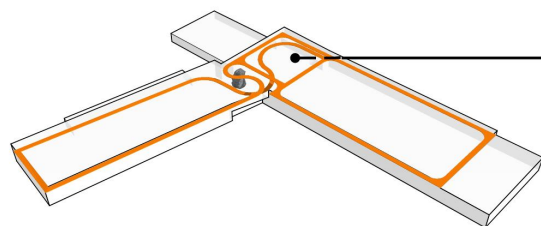

adventure / running
track

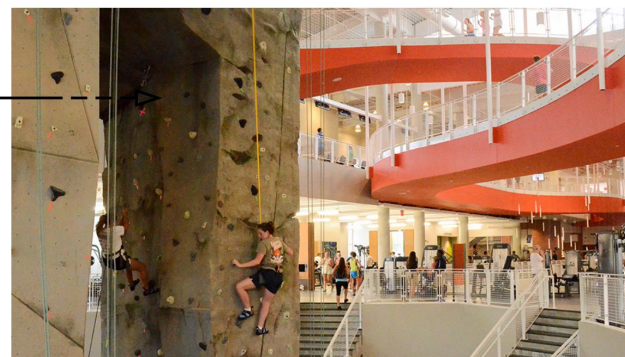

PROGRAMMING

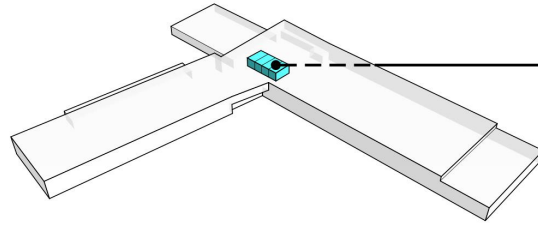

racquetball

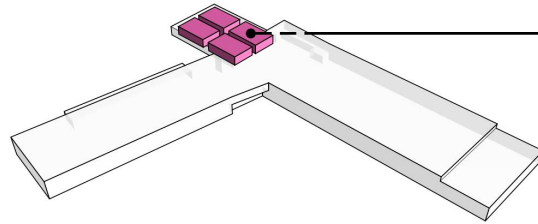
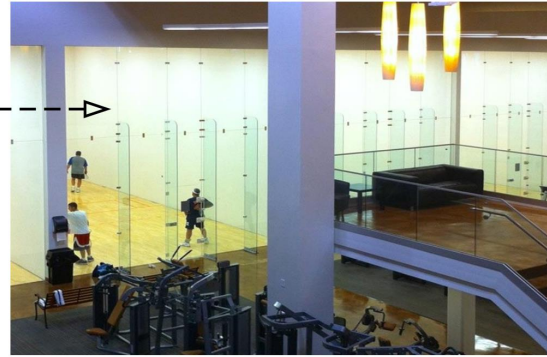

volleyball

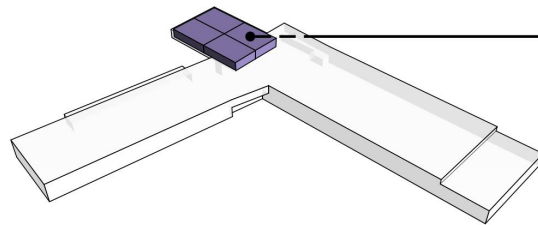

basketball

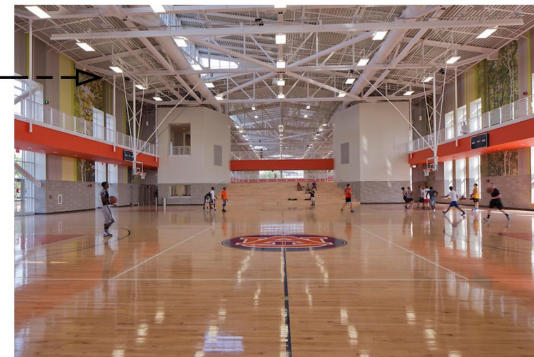

PROGRAMMING

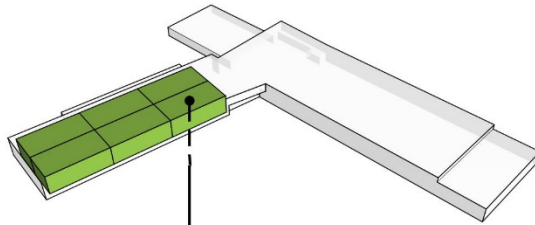

tennis

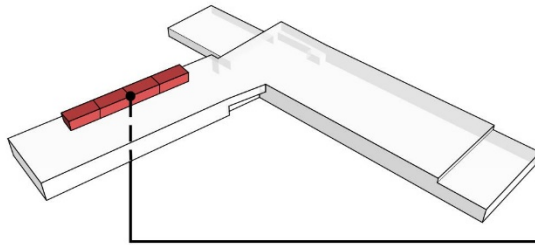
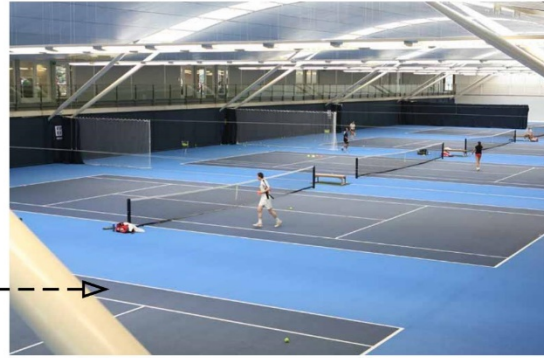

pickleball

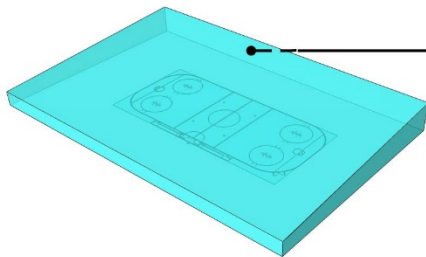

ice



PROGRAMMING

Next Steps

- ❖ Board Meeting Thursday, October 17th
- ❖ Draft Plan Presentation Wednesday, November 20th Public Meeting
Capital Ice Complex, 1504 Wichita Drive at 6:30 pm
- ❖ Thursday, November 21st Board Meeting
Tom Baker Room, 221 North 5th Street at 5:15 pm
- ❖ Final Presentation to Board December 19th by UBL Design and Bismarck staff
Tom Baker Room, 221 North 5th Street at 5:15 pm

Other comments, suggestions,
feedback?

Thank You For Your Time



NATIONAL GOLD MEDAL WINNER
BISMARCK PARKS AND
RECREATION DISTRICT
Est. 1927

Pat O'Toole

Direct: 303.345.1804
Pato@greenplayllc.com

Tom Diehl, CPRP

Direct: 804.833.6994
Tdiehl@greenplayllc.com

Jeff Ubl, AIA

Direct: 701.751.4555
jeff@ubldesign.com

